



LFC™_7 Energy Dissipators

Overview:

The LFC™_7 energy dissipator is a custom designed piece of equipment that reduces the upstream pressure to the designed ratio at a specific designed flow rate.

The LFC™_7 energy dissipator has been developed to present a robust, simple and cost effective method to reduce pressure at a set flow rate in open ended pipes. It will typically be used with a dam level control valve or a column drain valve. The dissipator will ensure that the pressure is discharged from the open end at a safe pressure. The LFC™_7 energy dissipator will increase the life of the valve upstream of it as the valve will not be required to throttle or break pressure. The high wear task is undertaken by the dissipator.

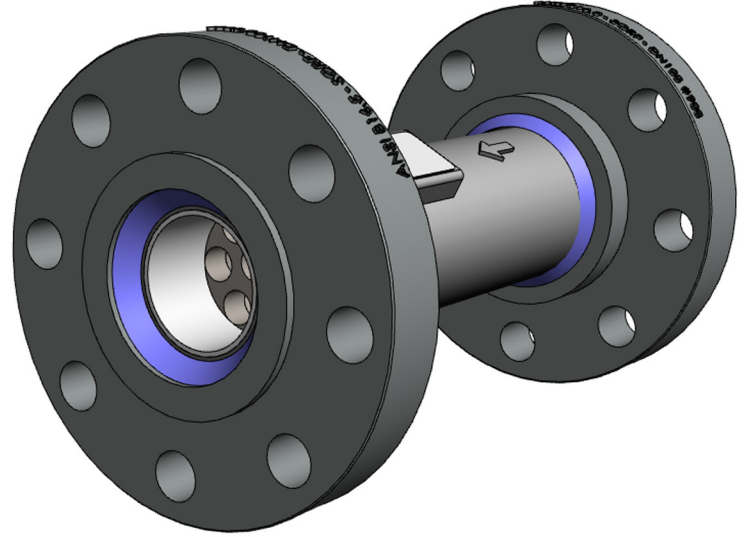

Operating Conditions:

The LFC™_7 energy dissipator have a series of orifices that break pressure and reduce flow over each stage.

Noise Level:

The LFC™_7 energy dissipator is relatively quiet compared to other dissipators in the market place.

Dimensions:

Unit	Face to face dimensions (popular sizes only)									
	#150		#300		#600		#900		#1500	
	(mm)	(inch)	(mm)	(inch)	(mm)	(inch)	(mm)	(inch)	(mm)	(inch)
DN50 / 2"	203	7.99	267	10.51	292	11.50	368	14.49	368	14.49
DN80 / 3"	241	9.49	318	12.52	356	14.02	381	15.00	270	10.63
DN100 / 4"	292	11.50	356	14.02	431	16.97	457	17.99	546	21.50
DN150 / 6"	356	14.02	445	17.52	559	22.01	610	24.02	705	27.76
DN200 / 8"	495	19.49	559	22.01	660	25.98	737	29.02	832	32.76
DN250 / 10"	622	24.49	622	24.49	787	30.98	838	32.99	991	39.02
DN300 / 12"	699	27.52	711	27.99	838	32.99	965	37.99	1130	44.49
DN350 / 14"	787	30.98	762	30.00	889	35.00	1029	40.51	1257	49.49
DN400 / 16"	914	35.98	838	32.99	991	39.02	1130	44.49	1384	54.49

Design & Manufacturing Standards:

The LFC™_7 Energy Dissipator Range has been designed in accordance with various international standards as set out below:

ASME Boilers and pressure vessels design code

ANSI B16.10 ANSI B16.3

ANSI B16.34 ANSI B16.37

ANSI B16.5 ANSI N278.1

Available sizes: DN12 / 1/2" to DN1000 / 40"

Pressure rating: up to 25MPa / 3 626 psi

Face to face dimensions: ANSI B16.10

Available end connections: ANSI B16.5, BS4504, BS10, AS/NZS 4331.1 (ISO 7005-1)

DIN, all makes of grooved or ring joint couplings, and other as per clients requirement.

Materials Of Construction:

Part Name	Material Specification
Body #1	ASTM A105 Grade B
Body #2	Hollow bar ST52
Stages	431 S/Steel hardened
Spacers	ASTM A105 Grade B
Stopper	Carbon steel